



**28 Croft Road**  
**, Newmarket CB8 0AQ**



- \*No Onward Chain\*
- \*Bright and Spacious Property\*
- \*Garage and Off Road Parking\*
- \*Newly Redecorated throughout and in immaculate condition\*
- \*Sunny Courtyard Garden\*
- \*Ideal Investment Property\*
- \*Walking distance to Newmarket Town Centre\*
- \*Proven Rental Track Record\*

**Offers in the region of £260,000**

13 High Street,  
Newmarket, Suffolk CB8 8LX

01638561187  
newmarket@wlea.co.uk  
www.wlea.co.uk

## Description

Bright and spacious 3 Bedroom property in Newmarket. This modern townhouse is in an immaculate condition and viewing is highly recommended.

Accommodation comprising of an Entrance Hall, large Kitchen/ Breakfast Room, Lounge, Three Bedrooms and Two Bathrooms. Externally benefitting from a private courtyard garden to the rear, Garage and Off Road Parking.

\* Offered For Sale with no Onward Chain. Ideal First Time Buy or an Investment Purchase \*



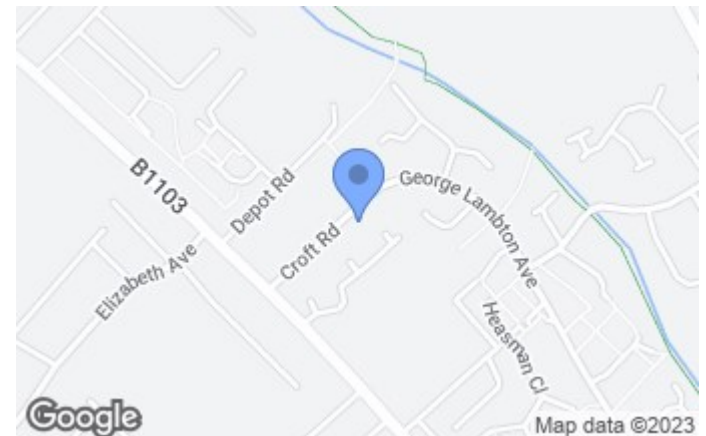

GROUND FLOOR  
392 sq.ft. (36.4 sq.m.) approx.

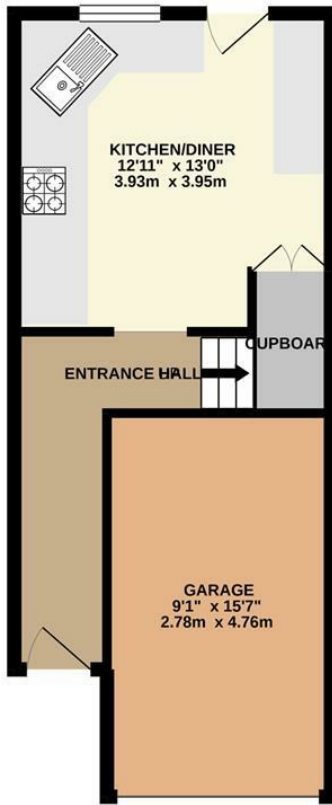

1ST FLOOR  
411 sq.ft. (38.2 sq.m.) approx.

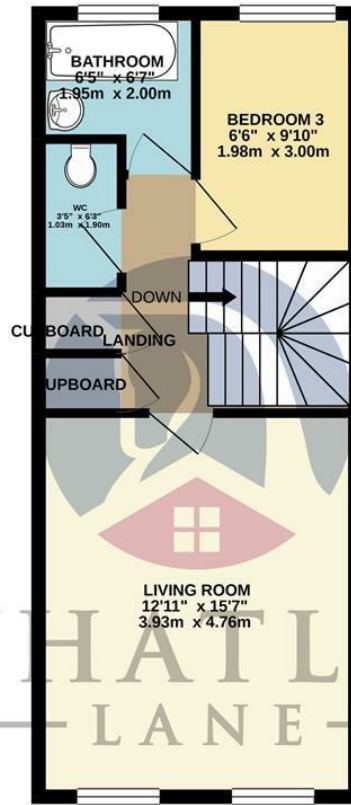

2ND FLOOR  
411 sq.ft. (38.2 sq.m.) approx.



WHATLEY  
LANE

28 CROFT ROAD NEWMARKET

TOTAL FLOOR AREA : 1214 sq.ft. (112.8 sq.m.) approx.

Whilst every attempt has been made to ensure the accuracy of the floorplan contained here, measurements of doors, windows, rooms and any other items are approximate and no responsibility is taken for any error, omission or mis-statement. This plan is for illustrative purposes only and should be used as such by any prospective purchaser. The services, systems and appliances shown have not been tested and no guarantee as to their operability or efficiency can be given.  
Made with Metropix ©2021

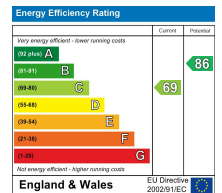

**BURY ST. EDMUNDS**

1 Churchgate Street  
Bury St. Edmunds, IP33 1RL  
+44 (0)1284 765 256  
bury@wlea.co.uk

**LONDON**

Caxton Gate, 32 Caxton Road  
London, W12 8AJ  
+44 (0)207 221 8838  
nottinghill@wlea.co.uk

**NEWMARKET**

13 High Street  
Newmarket, CB8 8LX  
+44 (0)1638 561 187  
newmarket@wlea.co.uk

[www.wlea.co.uk](http://www.wlea.co.uk)

